

# WORK<sup>PRO</sup>® **W**

## NEO 5A BT

**BLUETOOTH Control**



**User Manual / Manual de Uso**

Rev 15.06.01

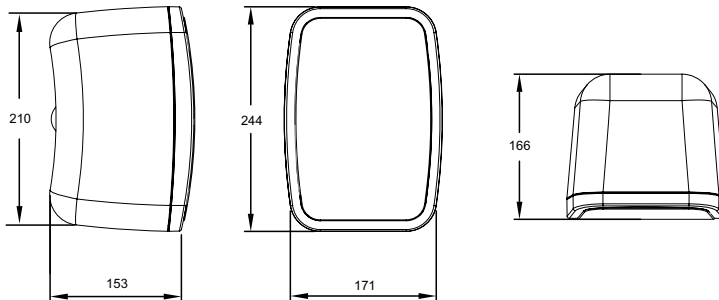

The powerful, elegant and high quality performance installation loudspeakers of the NEO Series, now include the convenience of Bluetooth Control. The new self-powered two way loudspeakers **NEO 5 A BT** offers a 30 metres indoor line of sight (LOS), offering a free control of the audio system. With this new feature, the audio input possibilities have been duplicated: users can choose conventional audio input signal through input connectors as well as Bluetooth control, using an external device to send audio files through this protocol.

Designed for fixed installations, this loudspeaker incorporates a Class D amplifier with volume and two tone controls for minimal weight and heat. They are provided in pairs (active + passive) and in black or white finish for a best adaptation to different types of projects.

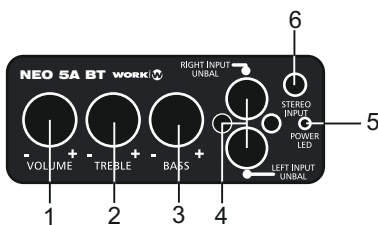

### NEO 5A BT

1	Volume Control
2	Treble Control
3	Bass Control
4	L/R Unbalanced Input (RCA connectors)
5	LED power
6	Stereo input (Mini-jack 3.5 mm)

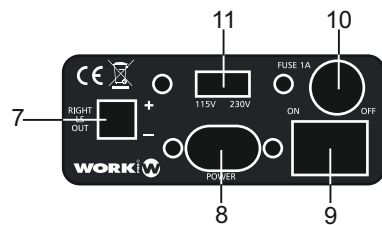

7	Link connection 2-pin euroblock (Passive unit)
8	Mains supply input (Use the included cable)
9	Power Switch ON/OFF
10	Fuse Holder
11	AC 115V/230V main power selector

Elements.....	5" Woofer + 0,5" Tweeter
Power Output .....	2 x 25 W RMS
Input Sensitivity.....	1V /2.21 dBu
Frequency Response .....	60Hz - 20kHz
Dispersion (H x V) .....	90° x 80°
Dimensions .....	171 x 244 x 166 mm
Material (enclosure) .....	ABS plastic
IP rating .....	IP 54
RAL colour code .....	RAL 9003 (W) / RAL 9004 (B)
Material (grille) .....	Aluminium
Weight .....	4,4 Kg

Specifications are subject to change without notice

When you active Bluetooth connection in your device, found the different Bluetooth compatible devices. **NEO 5A BT** will be found with the name "**BT SPEAKER**"

## IP54 weather proof rating

The NEO Active/Activas is rated to IP54 which means there is limited dust and water ingress protection.

The NEO Active/Activas is designed for both indoor and outdoor operation where it is protected from direct exposure to water (e.g. under a canopy). The use of protection from water and humidity for the connection terminals is highly recommended (e.g. sealant/mastic).

## Plastic Wall-mount bracket (NEO 5A BT)

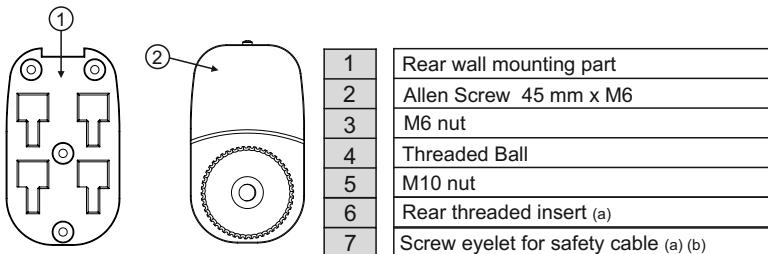

(a) Mounted to loudspeaker



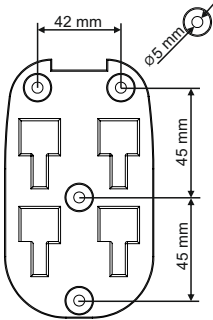

figure 1

## Mounting Process

Use the wall mounting part (1) to mark the fixing points on the wall. Take into account the dimensions between holes and the diameters marked in figure 1. Drill wall and insert wall fixings. Screw wall mounting part to wall. Ensure that suitable screws and wall fixings are used. If in any doubt contact a suitably qualified expert.

Mount (3), (4) & (5) as shown in figure 2. Screw the threaded ball (4) into the threaded insert on the rear of the loudspeaker (6) (loudspeaker not shown below). Tighten M10 nut (5) against the loudspeaker with a spanner. The assembly will now be as shown in figure 3.

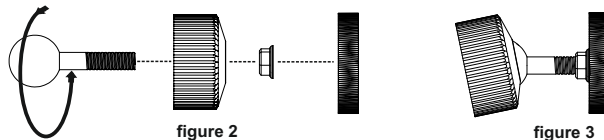

figure 2

figure 3

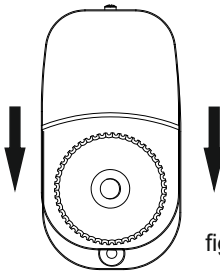
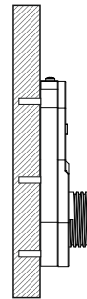
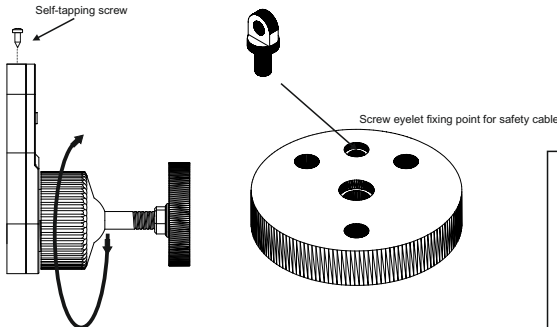

figure 4

Slide the hooks of the front threaded part (2) down in to the slots of the wall mount part (1). (figure 4)



Screw on the rotary knurled ring (3) several turns (do not tighten completely). Now adjust the loudspeaker to the desired position. Hold the speaker in position and tighten the knurled ring (3) completely. Use the self tapping screw (7) provided in order to lock parts (1) & (2) together.



**WARNING:** The maximum loading of this bracket (8 kg), must never be exceeded. No other items must be suspended or attached to the bracket or speaker enclosure.

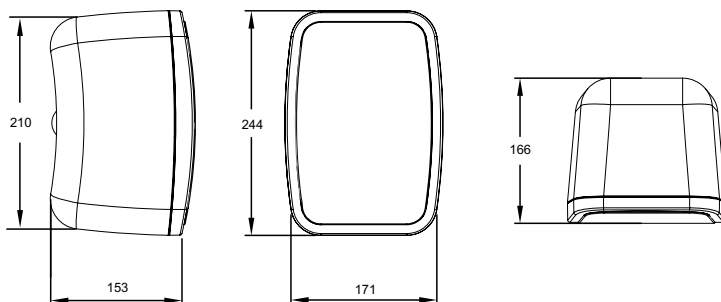

Los altavoces de instalación potentes, elegantes y de alta calidad de la serie NEO, ahora incluyen una versión con control Bluetooth. Los nuevos altavoces autoamplificados de 2 vías **NEO 5A BT** ofrece un alcance en interior de 30 metros (LOS), que ofrece un control libre del sistema de audio. Con esta nueva función, las posibilidades de entrada de audio se han duplicado: los usuarios pueden elegir la señal de entrada de audio convencional a través de conectores de entrada, así como control Bluetooth, usando un dispositivo externo para enviar archivos de audio a través de este protocolo.

Diseñado para instalaciones fijas, este altavoz incorpora un amplificador de clase D con volumen y dos controles de tono para el mínimo peso y. Se presentan en parejas (activo + pasivo) y en acabado blanco o negro para una mejor adaptación a diferentes tipos de proyectos

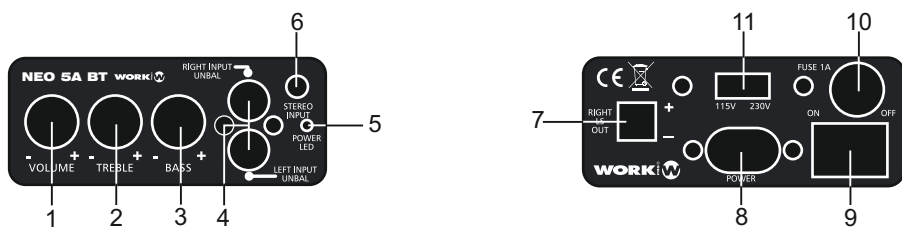

## NEO 5A BT

1	Control Volume
2	Control Treble
3	Control Bass
4	Entrada L/R desbal. (conect. RCA)
5	LED power
6	Entrada estéreo (Mini-jack 3.5 mm)

7	Conex. Link 2-pin euroblock (Unidad pasiva)
8	Mains supply input (Use the included cable)
9	Interruptor ON/OFF
10	Fusible
11	Selector de voltaje AC 115V/230V

Elementos.....	5" Woofer + 0,5" Tweeter
Potencia de Salida .....	2 x 25 W RMS
Sensibilidad de entrada.....	1V /2.21 dBu
Respuesta en frecuencia .....	60Hz - 20kHz
Dispersión (Hx V) .....	90° x 80°
Dimensiones .....	171 x 244 x 166 mm
Material (recinto) .....	Plástico ABS
Rnago IP .....	IP 54
Código color RAL .....	RAL 9003 (W) / RAL 9004 (B)
Material (rejilla) .....	Aluminio
Peso .....	2,7 Kg

Las especificaciones están sujetas a cambio sin previo aviso.

Cuando active la conexión Bluetooth en su dispositivo, encontrará diferentes dispositivos compatibles con Bluetooth. **NEO 5A BT** lo encontrará con el nombre de "**BT SPEAKER**"

## Rango de protección IP54

La serie NEO dispone de un rango de protección IP 45, el cual significa que tiene una protección limitada al ingreso de agua y polvo.

La serie NEO está diseñada tanto para instalaciones en interior como exterior donde está protegida de la exposición directa al agua (debajo de un dosel). Es muy recomendable el uso de protecciones contra el agua o la humedad en los terminales de conexión (p.e. sellándolos con silicona o masilla).

## Soporte de plástico (NEO 5A BT)

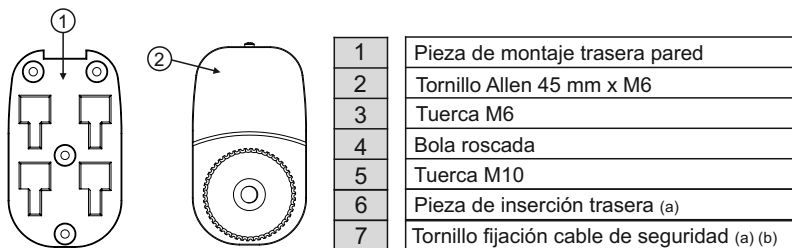

(a) Montado en el altavoz



## Proceso de Montaje

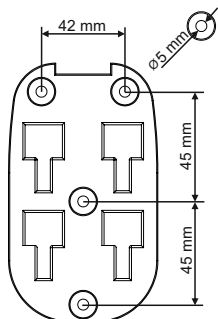

figure 1

Use la pieza de montaje (1) para marcar los puntos de fijación a la pared. Tenga en cuenta las medidas y diámetros marcados en la figura 1.

Fije la pieza a la pared. Asegúrese de fijarlo con todos los tornillos. Si tiene cualquier duda, consulte con un técnico.

Monte las piezas (3), (4) y (5) como muestra la figura 2. Atornille la pieza (4) dentro de la inserción roscada del altavoz (6). Fije la tuerca M10 (5) contra el altavoz.

El montaje se muestra en la figura 3.

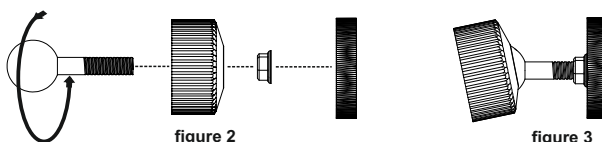

figure 2

figure 3

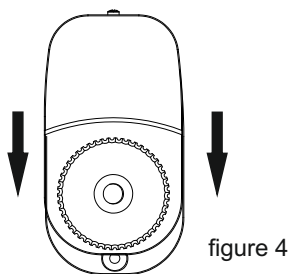
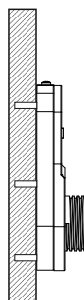

figure 4

Deslice la pieza frontal sobre la pieza montada en la pared (figura 4)



Atornille el aro rotativo (3) varias veces (sin fijarlo totalmente).

Ahora ajuste el altavoz en la posición deseada.

Fije el altavoz y apriete el aro (3) completamente.

Use el tornillo de fijación del cable (7).

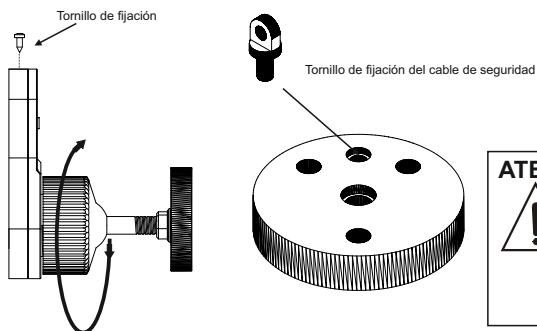

**ATENCIÓN:** La carga máxima soportada por este soporte (8 kg), no debe sobrepasarse. No se debe utilizar para la fijación de un elemento distinto de estos modelos de altavoz.



This symbol on the product or on its packaging indicates that this product shall not be treated as household waste. Instead it shall be handed over to the applicable collection point for the recycling of electrical and electronic equipment. By ensuring this product is disposed of correctly, you will help prevent potential negative consequences for the environment and human health, which could otherwise be caused by inappropriate waste handling of this product. The recycling of materials will help to conserve natural resources. For more detailed information about recycling of this product, please contact your local city office, your household waste disposal service or the shop where you purchased the product.

Manufactured by **EQUIPSON, S.A.**  
<http://www.equipson.es>